

GLANCE

(Model HEHGL AU)

Heat Output	▪	10.0kW av
Efficiency	▪	60% av
Coverage	▪	up to 180m ²
Emissions	▪	1.2 grams/kg



Hergom has teamed up with the design studio Strand+Hvass to create a cast iron wood burning fireplace that is beautiful, innovative and practical.

Located in Copenhagen, the work of Christina Strand and Niels Hvass relies on the Nordic design tradition: keep it simple and clean. Simplicity and well-balanced lines combine to make the Glance truly unique. That's the reason the Glance series of fireplaces is deeply rooted in the Scandinavian culture.

Hergom is today one of the leading companies in the sector worldwide, with five manufacturing and operations points in Europe and America. They have been recognized with a multitude of awards and prizes, including the Hearth & Home award for best stove in 2018, in the United Kingdom, which was awarded to the Glance.

The smallest details of this fireplace are designed to delight - like the 180° view of the flames from the channels carved from cast-iron. Or the advanced double combustion system that allows for a cleaner more efficient burn. In addition the built in cast iron finishes guarantee a high quality finish, high resilience and optimal heat transfer.

The distinctive aesthetics of the Glance make it an undisputed focal point in any room.

Clearances

Hearth	Width	Depth	Thickness
Parallel No Shielding depth inc 450mm in front. Thickness: Equal to 18mm Bellis Board or equivalent	970	1261	18
Parallel with Firebox Heat Shield depth inc 450mm in front. Thickness: Equal to 18mm Bellis Board or equivalent	970	1161	18
Parallel with Firebox Heat shield & Flue Shield depth inc 450mm in front. Thickness: Equal to 18mm Bellis Board or equivalent	970	1036	18

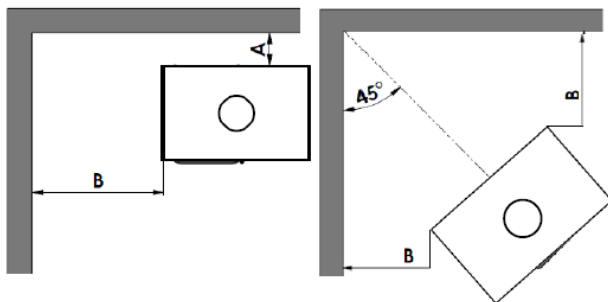

Dimensions

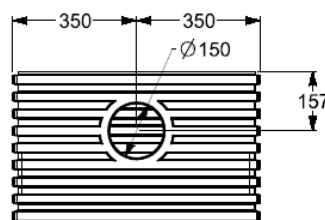
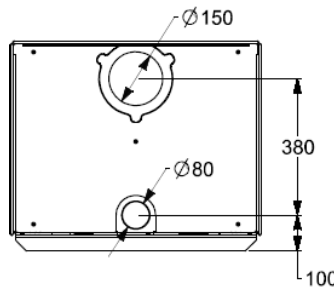
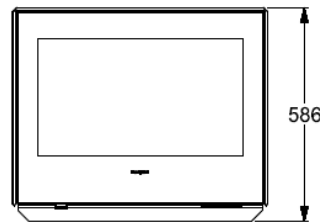

Features

STANDARD FEATURES

- Constructed from cast iron
- High density vermiculite lining system insulates the combustion chamber, providing better heat reflection
- Advanced double combustion system allows for a cleaner and more efficient burn by injecting air into the firebox and reigniting un-burnt particles
- 180° view of the flames from channels carved from cast iron
- Superior air wash system keeps the glass clean for unparalleled fire viewing
- Removable ash-draw for a clean convenient disposal of ashes
- Vertical smoke exit through the top with the option to switch to a Horizontal smoke exit through the Rear
- Weight 185kilos
- Maximum log width : 550mm
- Flue Spigot Size : Ø 150mm 6inch
- Internal Firebox : 565[w] x 305[d] x 253-3335[h]
- Viewing Area : 560[w] x 305[h]
- Warranty: Limited 2 years manufactures

OPTIONAL ACCESSORIES

- Black Steel Bench 1490[w] x 500[d] x 350 [h]

Information supplied is to assist you in your choice of a suitable fire. It is not intended to be all the information required to install the fire and does not replace the installation manual which provides more detailed information. In the interest of product development Hergom reserves the right to change specifications without prior notice.

All measurements are in millimetres unless otherwise stated.

Flue Shield Configuration	Rear [A]	Side [B]	Front	Corner
No shielding	400	400	450	150
Firebox Rear Heat Shield	300	475	450	150
Heat Shield and Flue Shield	175*	475	450	150

CLEARANCES BASED ON INSTALLATION WILDCAT 6" TRIPLE SKIN FLUE KIT WITH 8" SOLID CASINGSOLID DECORATIVE FLUE SHIELD

