

CPT Concealed Post Base

Keep it Hidden

SIMPSON
Strong-Tie



Typical CPT installation (ZMAX® 140 mm version shown)

The CPT Concealed Post Base provides a clean look to expose the natural beauty of the timber.

Reduce the potential of timber decay at the post end with a 25 mm standoff.

Features and Benefits

- Tested and load-rated for uplift, download and lateral load.
- Simpson Strong-Tie saves installers' time by providing all the necessary components to make the connection in one pack.
- Can either be cast-in-place or retrofitted with adhesive or mechanical anchors.
- CPTZ versions feature ZMAX® galvanisation that gives additional corrosion protection in outdoor or preservative-treated wood applications. The standoff base has an additional textured, flat black powder coat finish for aesthetic purposes.
- CPTSS is made entirely of 316 Stainless Steel, for highly corrosive environments such as coastal areas or around pools.



Material

- 2.7 mm thick (base), 3.5 mm (knife plate).

Finish

- ZMAX® Galvanisation (CPTZ)
- 316 Stainless Steel (CPTSS)
- For further details refer to corrosion information

Corrosion Resistance Level
MEDIUM
Corrosion Resistance Level
SEVERE

Installation

- Use all specified fasteners. See General Notes.
- Post bases do not provide adequate resistance to prevent members from rotating about the base and therefore are not recommended for non-braced or non-top-supported installations.

CPT Concealed Post Base

Keep it Hidden

SIMPSON
Strong-Tie

Typical Installation

1. Use the knife plate as a template to mark dowel locations.
2. Drill $\frac{1}{2}$ " (12.7 mm) holes perpendicular to the post at marked locations.
3. Cut a 5mm wide slot on the side adjacent the drilled holes with a 127 mm clearance for the knife plate. Check that the knife plate slides freely.
4. Fix down the knife plate to concrete foundation and lower the standoff over the knife plate.
5. Lower the post onto the knife plate with the drilled holes aligned with the three holes in the knife plate. Be careful to avoid rotating the post during installation.
6. Drive the dowels into the post. They should be roughly centred within the post.

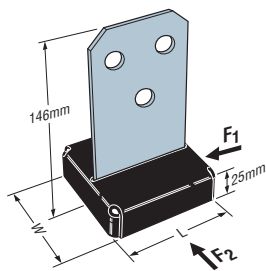
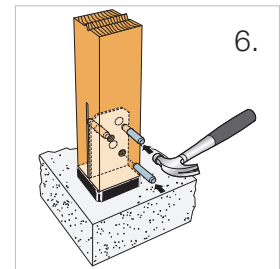
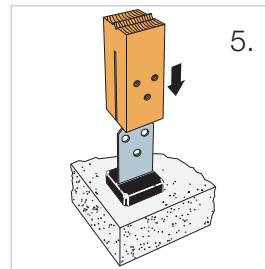
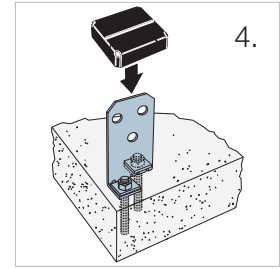
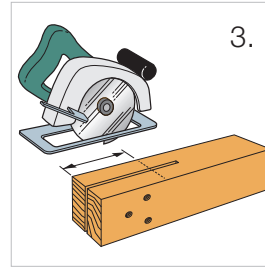
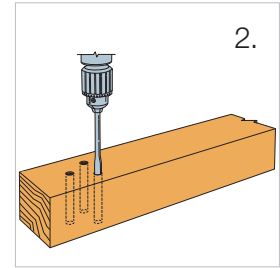
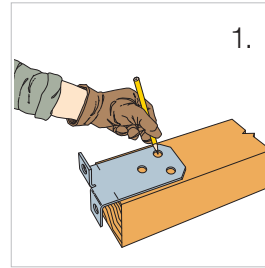

CPT90Z
(others similar)

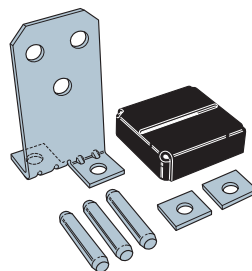

CPT90Z components
(others similar)

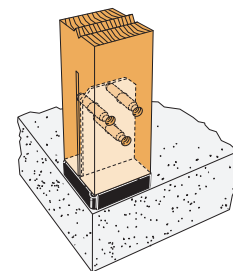

Typical CPT90Z installation

Model No.	Description	Dimensions (mm)		Barcode	Pack Qty	Ctn Qty	Pack Dims (WxLxH) and weight	
		W	L				Carton Dims (WxLxH) and weight	
CPT90SS	Suits 90 mm sq. post	89	89	707392210979	1	10	100 x 75 x 155 mm	0.95 kg
							210 x 410 x 180 mm	9.82 kg
CPT90Z	Suits 90 mm sq. post	89	89	707392420934	1	10	100 x 75 x 155 mm	0.97 kg
							210 x 410 x 180 mm	9.83 kg
CPT115Z	Suits 115 mm sq. post	114	114	707392014379	1	10	100 x 75 x 155 mm	1.14 kg
							210 x 410 x 180 mm	11.4 kg
CPT140Z	Suits 140 mm sq. post	137	137	707392342595	1	8	155 x 142 x 100 mm	1.62 kg
							170 x 210 x 585 mm	13.32 kg
CPT200Z	Suits 190 mm sq. post	184	184	707392505327	1	6	190 x 190 x 100 mm	2.05 kg
							210 x 205 x 605 mm	12.62kg